

S-SERIES SEDAN MOTORYACHTS

Martimo[®]

OCEANS APART







LUXURY AND PERFORMANCE IN PERFECT HARMONY

Built in Australia by the finest craftsman, Maritimo blends its race honed performance pedigree with Australia's easy living approach to create luxury boating with rugged blue water credentials.

We are dedicated to crafting distinctive high quality motoryachts that are thoughtfully laid out and luxuriously finished. Each offers its owner timeless elegance and unparalleled abilities in the water.

Maritimo®

OCEANS APART

CONTEMPORARY STYLE MEETS INTELLIGENT LUXURY AND PERFORMANCE.

The Maritimo S-Series offers you a sleek, low slung sedan exterior style ideal for height constricted waterways. The all-in-one interior layout is suited to those who prefer the bridge integrated on a single level with the lounge and entertaining area.

Underneath the hand crafted wood, fine leather and clever ergonomics you'll find the best in nautical design that ensures simplicity, efficiency and cruisability.

When it's time for deep-water action you'll find Maritimo's racing edge more than meets the demands of the sports fisherman and high performance island-hoping adventure.

AFT GALLEY

Whether you're entertaining in the cockpit or saloon, the chef remains part of the conversation with Maritimo's aft galley arrangement and wide opening bi-fold doors. Fitted out with Miele appliances including a full stand up dishwasher, speed oven, cook top with range hood and refrigerator with in-built ice maker.

FULL BEAM MASTER CABIN

Every Maritimo S-Series motoryacht provides a full beam master cabin with king or queen size bed, ensuite and chaise lounge.





BI-FOLD DOORS

Unique bi-fold doors open up the whole living space in to one large entertaining area. Entertaining is a breeze with the galley as the centre of the action and the island bench doubling as a cocktail bar. For those cooler days or to access the cockpit while running, you only need open one port side door.



WALK AROUND DECKS

The walk around side decks of a Maritimo allow safe and easy access to the foredeck, perfect for children and pets. Whether your pulling up a mooring, dropping anchor, tying up at a wharf, getting the lines and fenders ready, or for those who like to wet a line, you'll wonder how you ever managed without them.



EASY HANDLING AND BERTHING

Maritimo's ergonomic dashboards feature the latest large screen electronics and intuitively configured controls for easy handling. They can be fitted with optional docking thrusters to aid berthing and vessel control in tight confined canal type waterways or crowded marinas. Key engine controls are also replicated in the aft cockpit for simpler docking.



EFFICIENT RACE BRED SHAFT DRIVE

Smart, innovative, practical design lies at the heart of the Maritimo philosophy. Big ideas - like a low angle race bred shaft drive and our patented hand laid super strong hull ensures best in class efficiency and excellent sea going abilities. Attention to detail - like fitting instantly sighted fuel gauges and creating a simple concise electrical panel layout makes everyday boat management and long distance performance cruising straightforward and safe.







S62

THE MOTORYACHT THAT REDEFINES LUXURY MOTOR CRUISING

The S62 sedan motoryacht embodies Maritimo's refreshing approach to motoryacht design. This sleek flagship sedan offers you supreme power, superior nautical engineering, "best in class" fuel efficiency plus a relaxed on board living and entertaining thanks to a sumptuously finished contemporary single level bridge and saloon layout.

This is a serious ocean going luxury motoryacht yet with the helm and living area all on the same level, the low slung S62 is ideal for those who live on canals and waterways with low bridges



Twin Volvo 800 MHP engines place 1600MHP at your disposal, whilst Maritimo's race proven shaft drive and hull design technology ensures excellent fuel consumption for long range, high speed blue water cruising. You can island hop with ease, maintaining average speeds of 21 knots or more.

The S62 interior is elegant, smart and modern with three cabins and two bathrooms including a full beam master stateroom featuring a king size bed, ensuite, chaise lounge and make up vanity/study. Together with a beautifully appointed aft galley equipped with Miele appliances and spacious pantry, you'll want for nothing during long stays aboard.

There's relaxing room for everyone in the huge saloon where the already spacious single level, open plan layout is amplified by wide opening bi-fold saloon doors that bring the outside in. Open the sunroof, side windows (optional) and bi-fold doors and make the S62 an entertainer's dream - perfect for those lazy days lunching at your favourite spot.







Your personal taste can be accommodated in to the finished layout including a choice of fine leathers, luxury carpet, hand crafted timber detailing, convertible berths, relocatable tables and a wet bar.

S62 SPECIFICATIONS

| | | |
|-----------------------|-------------------------|--------------|
| LENGTH OVERALL | 19.16 M | 62' 11" FT |
| HULL LENGTH ISO | 18.84 M | 61' 10" FT |
| BEAM | 5.29 M | 17' 4" FT |
| DRAFT | 1.43 M | 4' 8" FT |
| DRY WEIGHT | 28,250 KG | 63,000 LBS |
| FUEL CAPACITY | 4,400 L | 1,160 US GAL |
| WATER CAPACITY | 800 L | 211 US GAL |
| HOLDING TANK CAPACITY | 300 L | 79 US GAL |
| SLEEPING CABINS | 3 | |
| SLEEPING CAPACITY | 5 STANDARD | 8 OPTIONAL |
| ENGINES (STANDARD) | 2 x VOLVO D13 - 800 MHP | |
| GENERATOR | CUMMINS - ONAN 21.5 KW | |

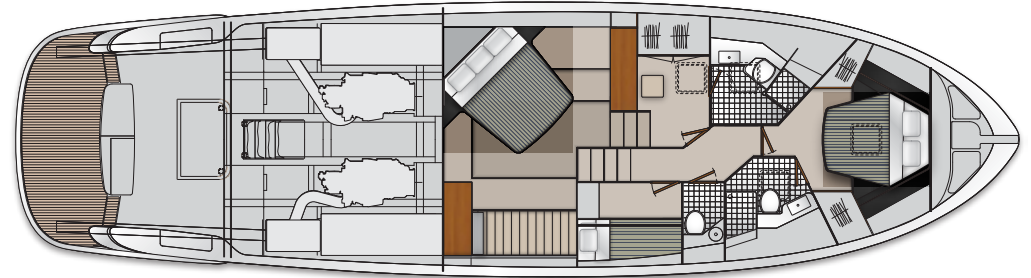
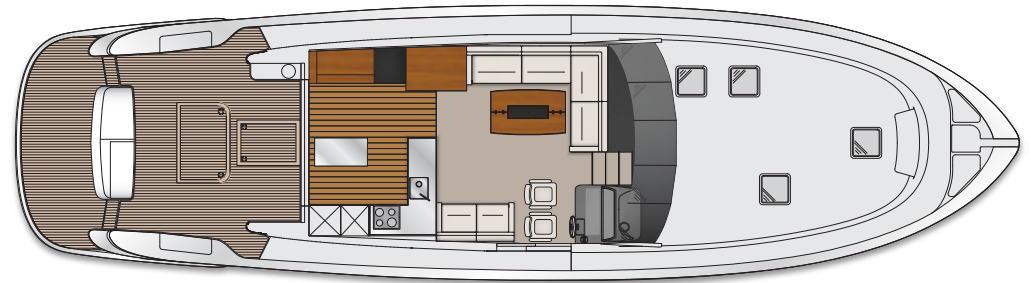





S54

THE COMPACT LUXURY ENTERTAINER

The Maritimo S54 sedan motoryacht sets its own performance and style benchmarks. Giving you the best in class, hand crafted luxury finishes and spacious layouts found in the S62 within a more compact hull.

The S54 offers you long-range sea legs and a beautiful apartment style interior taking entertainment to the next level.



This compact luxury entertainer is an easily managed motoryacht without the usual compromises.

All the Maritimo hallmarks are aboard - wide walk around decks, aft galley design with a full-size fridge, well-appointed pantry and top quality appliances. The full beam master cabin features a queen bed, ensuite and mezzanine level vanity/study. Family and friends are comfortably accommodated in the forward guest suite or bunks to starboard with a day head easily accessed by both. Aft bi-fold doors seamlessly blend the rear cockpit with the spacious saloon and bridge ensuring a breezy, easy living boat that's ideal for relaxed entertaining.

With twin Volvo D11 - 670 MHP engines powering you at an average cruising speed of 21 knots for up to 500 nautical miles and twin long range fuel tanks holding up to 1000 US gallons, this is 'go anywhere' luxury. The low angle straight shaft drive delivers a very comfortable 5 degree bow high cruise attitude for long range fuel efficiency and a motoryacht that handles rough seas with remarkable ease.







In keeping with all Maritimo motoryachts, your personal taste can be accommodated with a choice of high quality hand crafted contemporary finishes, including high gloss Wenge timber and the option of standard island, eurostyle, or sports fishing transoms.

S54 SPECIFICATIONS

| | | |
|-----------------------|-------------------------|--------------|
| LENGTH OVERALL | 16.505 M | 54' 2" FT |
| HULL LENGTH ISO | 16.275 M | 53' 5" FT |
| BEAM | 5.08 M | 16' 8" FT |
| DRAFT | 1.225 M | 4' FT |
| DRY WEIGHT | 21,250 KG | 46,850 LBS |
| FUEL CAPACITY | 3,800 L | 1,003 US GAL |
| WATER CAPACITY | 800 L | 211 US GAL |
| HOLDING TANK CAPACITY | 300 L | 79 US GAL |
| SLEEPING CABINS | 3 | |
| SLEEPING CAPACITY | 6 STANDARD | |
| ENGINES (STANDARD) | 2 X VOLVO D11 - 670 MHP | |
| GENERATOR | CUMMINS - ONAN 21.5 KW | |

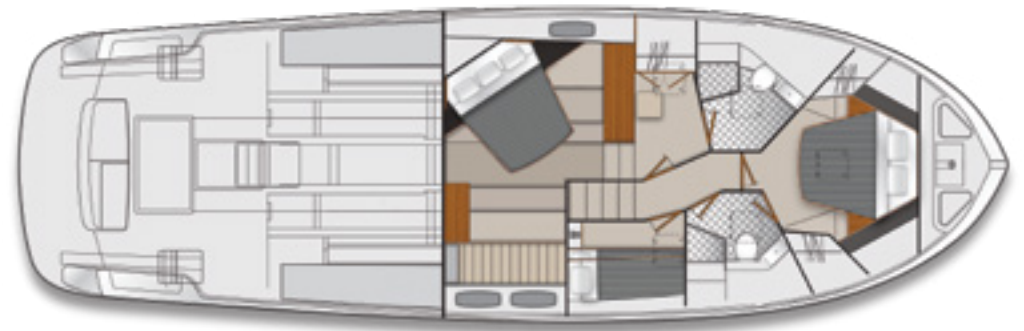





S51

A FRESH LOOK AT WHAT'S POSSIBLE WITHIN A COMPACT MOTORYACHT

The S51 embodies everything that the Maritimo approach to motoryacht design makes possible. Stylish and spacious this magnificent 51 footer provides all the facilities and benefits of our larger vessels in a more compact single level package.

Simple ideas that are often overlooked make all the difference - safe, wide, walk around decks and aft bi-fold doors to the rear cockpit, which together with a generously proportioned aft galley and the combined saloon and bridge amplify your living space.



Everywhere you look you'll find smart thinking that makes the most of every space. Ideas such as the electrically operated lazarette hatch in the cockpit (optional) which provides a large under deck area for a tender or water sports equipment. There's an easily accessible lazarette that can be fitted with large freezer, under floor fish bins, and optional live bait tanks to go along with the optional fishing transom.

When it's time for action, Maritimo's hull design and race-bred direct shaft drive create a boat with superb balance, poise and fuel efficiency. A unique approach which results in a rugged, yet easy to handle, 1340 horsepower powerhouse perfectly equipped to indulge your desire for fun and luxury.







Like all Maritimo motoryachts, the S51 comes with a five-year structural warranty ensuring thousands of hours of efficient, reliable running.

S51 SPECIFICATIONS

| | | |
|-----------------------|-------------------------|------------|
| LENGTH OVERALL | 16.19 M | 53' 1" FT |
| HULL LENGTH ISO | 15.93 M | 52' 3" FT |
| BEAM | 5.06 M | 16' 7" FT |
| DRAFT | 1.28 M | 4' 2" FT |
| DRY WEIGHT | 20,500 KG | 45,200 LBS |
| FUEL CAPACITY | 3,100 L | 818 US GAL |
| WATER CAPACITY | 500 L | 132 US GAL |
| HOLDING TANK CAPACITY | 300 L | 79 US GAL |
| SLEEPING CABINS | 3 | |
| SLEEPING CAPACITY | 5 STANDARD | |
| ENGINES (STANDARD) | 2 x VOLVO D11 - 670 MHP | |
| GENERATOR | CUMMINS - ONAN 13.5 kW | |

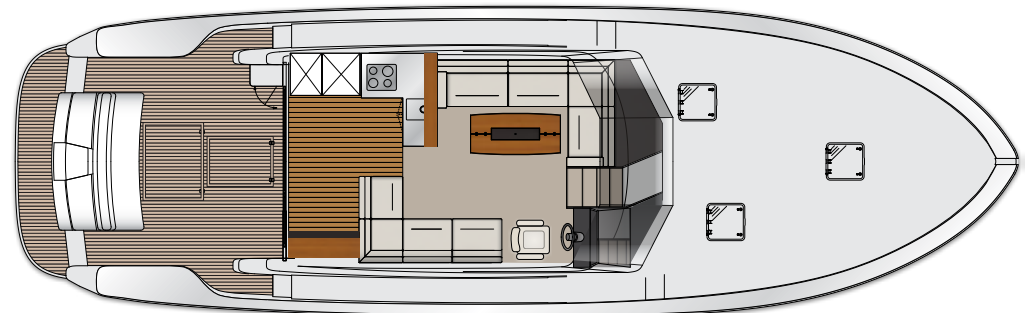

S70

NEW FOR 2017



S70 SPECIFICATIONS

| | | |
|-----------------------|-------------------------|--------------|
| LENGTH OVERALL | 21.51 M | 70' 7" FT |
| HULL LENGTH ISO | 21.215 M | 69' 7" FT |
| BEAM | 5.67 M | 18' 8" FT |
| DRAFT | 1.5 M | 5 FT |
| DRY WEIGHT | 42,000 KG | 92,600 LBS |
| FUEL CAPACITY | 6,300 L | 1,664 US GAL |
| WATER CAPACITY | 1,400 L | 370 US GAL |
| HOLDING TANK CAPACITY | 400 L | 106 US GAL |
| SLEEPING CABINS | 4 | |
| SLEEPING CAPACITY | 8 STANDARD | 12 OPTIONAL |
| ENGINES (STANDARD) | 2 x VOLVO D13 - 900 MHP | |
| GENERATOR | CUMMINS - ONAN 27.5 KW | |

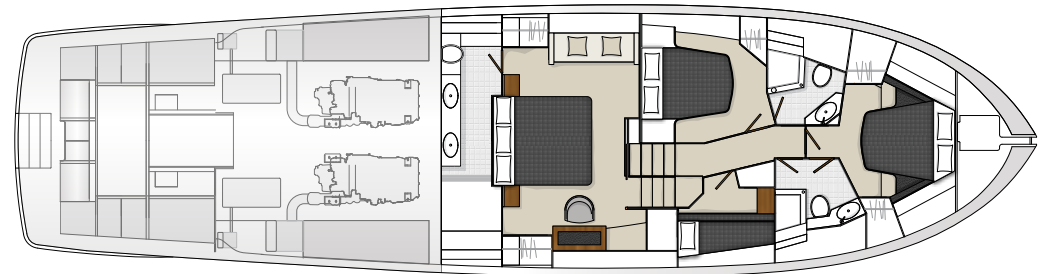
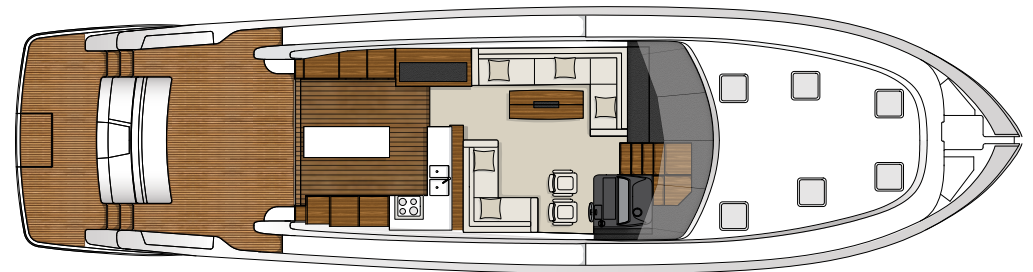

S64

NEW FOR 2017



S64 SPECIFICATIONS

| | | |
|-----------------------|-------------------------|--------------|
| LENGTH OVERALL | 19.51 M | 64' FT |
| HULL LENGTH ISO | 19.11 M | 62' 9" FT |
| BEAM | 5.67 M | 18' 8" FT |
| DRAFT | 1.415 M | 4' 8" FT |
| DRY WEIGHT | 38,000 KG | 83,800 LBS |
| FUEL CAPACITY | 5,600 L | 1,479 US GAL |
| WATER CAPACITY | 750 L | 198 US GAL |
| HOLDING TANK CAPACITY | 300 L | 80 US GAL |
| SLEEPING CABINS | 3 STANDARD | 4 OPTIONAL |
| SLEEPING CAPACITY | 6 STANDARD | 8 OPTIONAL |
| ENGINES (STANDARD) | 2 x VOLVO D13 - 900 MHP | |
| GENERATOR | CUMMINS - ONAN 21.5 KW | |

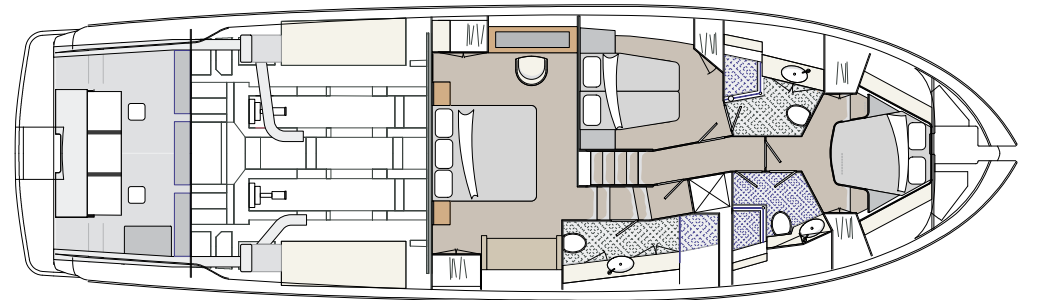
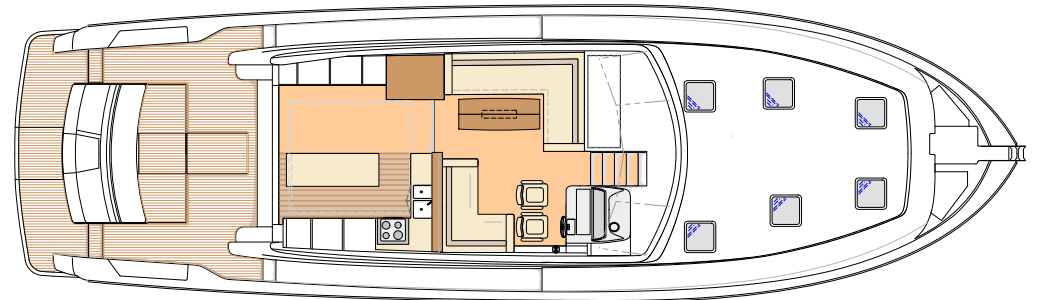

S59

NEW FOR 2017



S59 SPECIFICATIONS

| | | |
|-----------------------|-------------------------|--------------|
| LENGTH OVERALL | 17.98 M | 59' FT |
| HULL LENGTH ISO | 17.68 M | 58' FT |
| BEAM | 5.46 M | 17, 11" FT |
| DRAFT | 1.225 M | 4' FT |
| DRY WEIGHT | 26,000 KG | 57,320 LBS |
| FUEL CAPACITY | 4,400 L | 1,162 US GAL |
| WATER CAPACITY | 700 L | 185 US GAL |
| HOLDING TANK CAPACITY | 300 L | 80 US GAL |
| SLEEPING CABINS | 3 | |
| SLEEPING CAPACITY | 6 STANDARD | |
| ENGINES (STANDARD) | 2 x VOLVO D11 - 725 MHP | |
| GENERATOR | CUMMINS - ONAN 21.5 KW | |

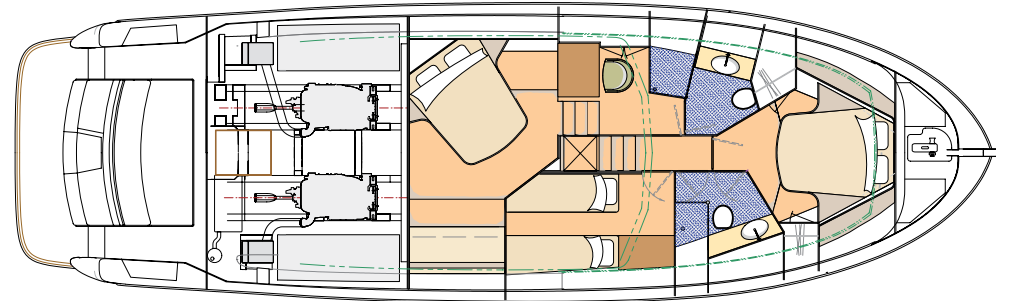
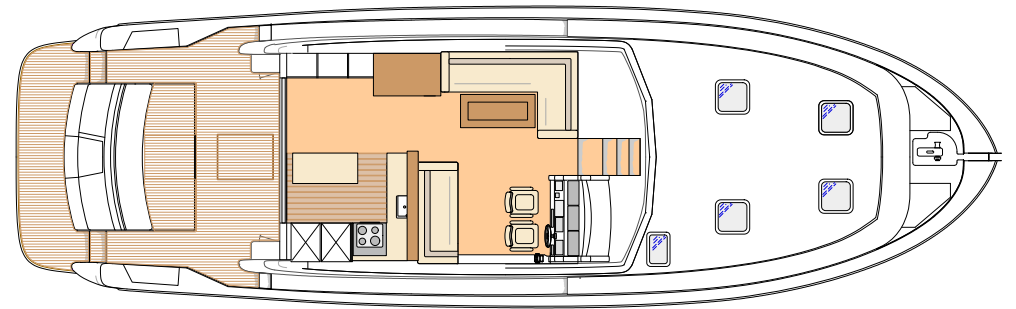





“With superior space, fuel efficiency and performance, the Maritimo S-Series is perfect for those looking for everything on a single level”

Bill Barry-Cotter
Maritimo Founder



THE CHOICE IS YOURS

The Maritimo S-Series offers you a range of great options and flexibility to personalise your motoryacht.



Maritimo make it easy through a logical series of steps to make your motoryacht a true expression of your individuality. You have a number of choices: from selecting your engines to exterior and interior colours, finishes and those detailed touches that define your character.

1

STEP 1 CHOOSE YOUR MODEL

Compare the standard features of each S-Series model and choose the one that best suits your lifestyle.

2

STEP 2 CHOOSE YOUR ENGINE

Most models offer a choice of powerful engines.

3

STEP 3 CHOOSE YOUR COLOUR

There's a wide range of possibilities for your hull colour to individualise your vessel..

4

STEP 4 CHOOSE YOUR INTERIOR

Personalise your own interior space from a carefully selected range of finishes and furnishings.

5

STEP 5 CHOOSE YOUR ACCESSORIES

Enhance your Maritimo further from our range of genuine accessories.

S-SERIES COMPARISON

S70

| | | |
|-----------------------|-------------------------|--------------|
| LENGTH OVERALL | 21.51 M | 70' 7" FT |
| HULL LENGTH ISO | 21.215 M | 69' 7" FT |
| BEAM | 5.67 M | 18' 8" FT |
| DRAFT | 1.5 M | 5 FT |
| DRY WEIGHT | 42,000 KG | 92,600 LBS |
| FUEL CAPACITY | 6,300 L | 1,664 US GAL |
| WATER CAPACITY | 1,400 L | 370 US GAL |
| HOLDING TANK CAPACITY | 400 L | 106 US GAL |
| SLEEPING CABINS | 4 | |
| SLEEPING CAPACITY | 8 | 12 OPTIONAL |
| ENGINES (STANDARD) | 2 x VOLVO D13 - 900 MHP | |
| GENERATOR | CUMMINS - ONAN 27.5 kW | |

S64

| | | |
|-----------------------|-------------------------|--------------|
| LENGTH OVERALL | 19.51 M | 64' FT |
| HULL LENGTH ISO | 19.11 M | 62' 9" FT |
| BEAM | 5.67 M | 18' 8" FT |
| DRAFT | 1.415 M | 4' 8" FT |
| DRY WEIGHT | 38,000 KG | 83,800 LBS |
| FUEL CAPACITY | 5,600 L | 1,479 US GAL |
| WATER CAPACITY | 750 L | 198 US GAL |
| HOLDING TANK CAPACITY | 300 L | 80 US GAL |
| SLEEPING CABINS | 3 | 4 OPTIONAL |
| SLEEPING CAPACITY | 6 | 8 OPTIONAL |
| ENGINES (STANDARD) | 2 x VOLVO D13 - 900 MHP | |
| GENERATOR | CUMMINS - ONAN 21.5 kW | |

S62

| | | |
|-----------------------|-------------------------|--------------|
| LENGTH OVERALL | 19.16 M | 62' 11" FT |
| HULL LENGTH ISO | 18.84 M | 61' 10" FT |
| BEAM | 5.29 M | 17' 4" FT |
| DRAFT | 1.43 M | 4' 8" FT |
| DRY WEIGHT | 28,250 KG | 63,000 LBS |
| FUEL CAPACITY | 4,400 L | 1,160 US GAL |
| WATER CAPACITY | 800 L | 211 US GAL |
| HOLDING TANK CAPACITY | 300 L | 79 US GAL |
| SLEEPING CABINS | 3 | |
| SLEEPING CAPACITY | 5 | 8 OPTIONAL |
| ENGINES (STANDARD) | 2 x VOLVO D13 - 800 MHP | |
| GENERATOR | CUMMINS - ONAN 21.5 kW | |

S59

| | | |
|-----------------------|-------------------------|--------------|
| LENGTH OVERALL | 17.98 M | 59' FT |
| HULL LENGTH ISO | 17.68 M | 58' FT |
| BEAM | 5.46 M | 17, 11" FT |
| DRAFT | 1.225 M | 4' FT |
| DRY WEIGHT | 26,000 KG | 57,320 LBS |
| FUEL CAPACITY | 4,400 L | 1,162 US GAL |
| WATER CAPACITY | 700 L | 185 US GAL |
| HOLDING TANK CAPACITY | 300 L | 80 US GAL |
| SLEEPING CABINS | 3 | |
| SLEEPING CAPACITY | 6 | |
| ENGINES (STANDARD) | 2 x VOLVO D11 - 725 MHP | |
| GENERATOR | CUMMINS - ONAN 21.5 kW | |

S54

16.505 M 54' 2" FT

16.275 M 53' 5" FT

5.08 M 16' 8" FT

1.225 M 4' FT

21,250 KG 46,850 LBS

3,800 L 1,003 US GAL

800 L 211 US GAL

300 L 79 US GAL

3

6

2 X VOLVO D11 - 670 MHP

CUMMINS - ONAN 21.5 KW

S51

16.19 M 53' 1" FT

15.93 M 52' 3" FT

5.06 M 16' 7" FT

1.28 M 4' 2" FT

20,500 KG 45,200 LBS

3,100 L 818 US GAL

500 L 132 US GAL

300 L 79 US GAL

3

5

2 x VOLVO D11 - 670 MHP

CUMMINS - ONAN 13.5 KW



RACING GENES

With a heritage in offshore racing, Maritimo provides world-class technology that excites all true boating enthusiasts with no compromise on luxury.

At 175mph, there is no such thing as over engineering. Intelligent weight distribution, light weight durable materials, precision components and full power steering creates smooth, exact and responsive performance.

Maritimo has been at the leading edge of offshore racing both in Australia and internationally and with these credentials no other manufacturer can match the technology and performance built into every Maritimo

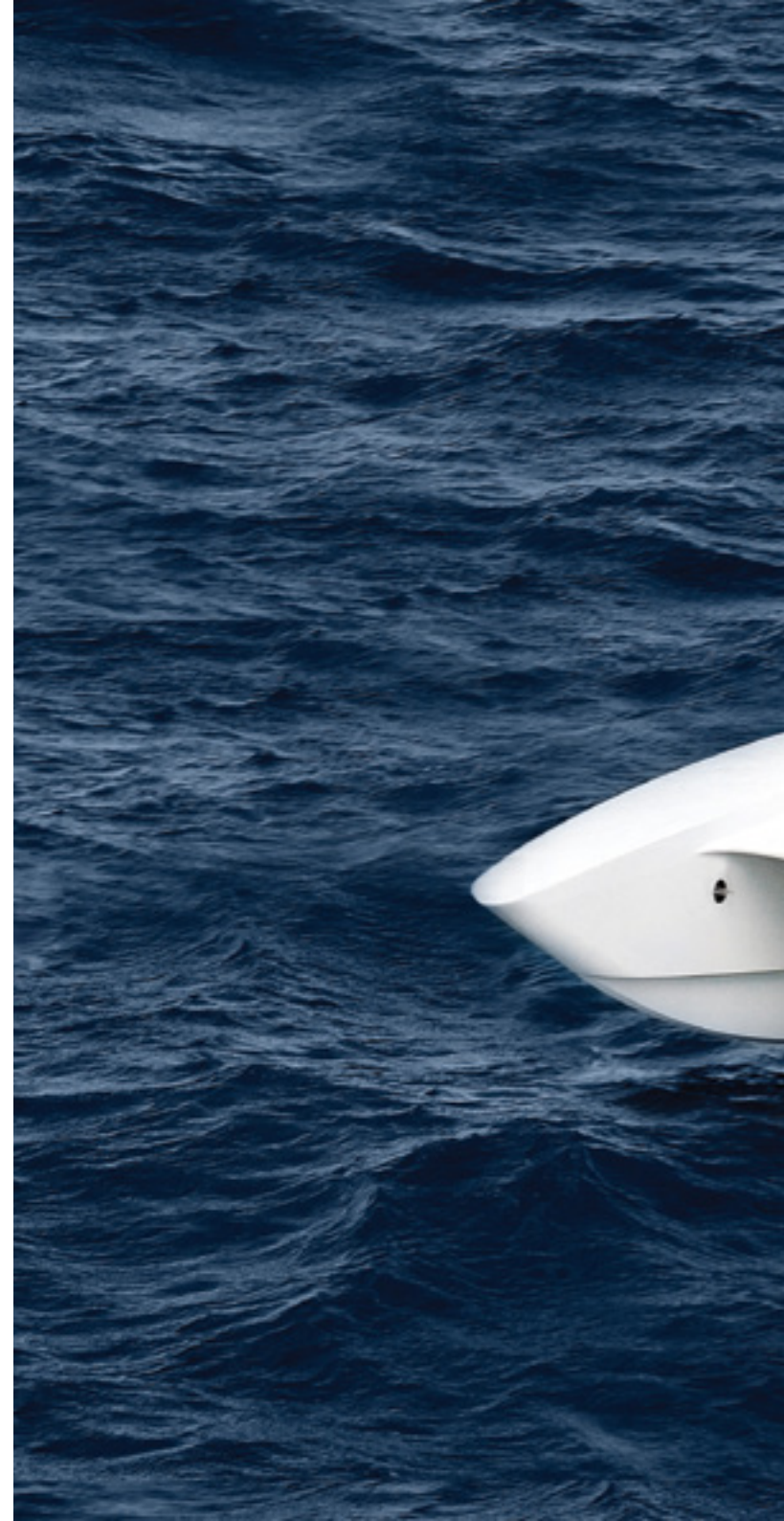



WS326Q

11

Martimo

LONG RANGE LUXURY MOTOR YACHTS

AUSTRALIA

THE WORLD OF MARITIMO



MARITIMO MUSTERS

As a proud Maritimo owner, become part of our story at one of our Maritimo Musters held around the world. Meet new friends, speak to our team about how each and every model is built, while your driving skills are put to the test.



GLOBAL BOAT SHOWS

Experiencing a Maritimo has never been easier with our dedication to an international boat show schedule across Australia, the Americas and Europe. This is an opportunity for you to be informed and entertained on Maritimo's latest models. Visit our website and social channels to find a boat show near you.
maritimo.com.au



MARITIMO VIP EVENTS

The benefits of owning a Maritimo extend beyond the pleasurable days out on the water. You become part of our family which provides a range of exclusive benefits for you to enjoy. From special VIP events across the world, the chance to be part of product development and 'experience days' with our brand partners, there's plenty to be involved in.



CONNECT WITH MARITIMO

Maritimo's digital world offers you the opportunity to connect. Our website, Facebook, Instagram, Twitter, LinkedIn and YouTube channels are filled with the latest Maritimo news, events and models, plus insights into the factory and offshore racing.



MARITIMO COLLECTION

Your motoryacht is just the beginning. The latest Maritimo Collection is now available for you to discover.

Meticulous attention to detail doesn't stop with our motoryachts. You'll find the same level of craftsmanship in our clothing. Partnering with Henri Lloyd, we have produced a range of premium clothing that is not only stylish but practical. So whether you're shopping for yourself or a loved one, you know the quality is assured.

The Maritimo Collection includes ladies and gents clothing as well as a range of bags and accessories. Visit our online shop at shop.maritimo.com.au.

DISCLAIMER

IMPORTANT NOTICE

Maritimo Offshore Pty Ltd is constantly seeking ways to improve the specifications, designs and production of its motoryachts and enhancements take place continually. Whilst every effort is made to ensure up to date literature, this brochure should not be regarded as an infallible guide to current specifications.

Always check with your authorised Maritimo consultant to ensure you have the latest specifications, options, and pricing as we reserve the right to change specifications, fittings, inventory and prices without notice.

© Copyright 2016 Maritimo Offshore Pty Ltd

Maritimo[®]
O C E A N S A P A R T





MARITIMO.COM.AU

Maritimo[®]

OCEANS APART

